



MA-63252-NKG
PNEUMATIC FILTER REGULATOR
Installation, Operation, and Maintenance Instructions



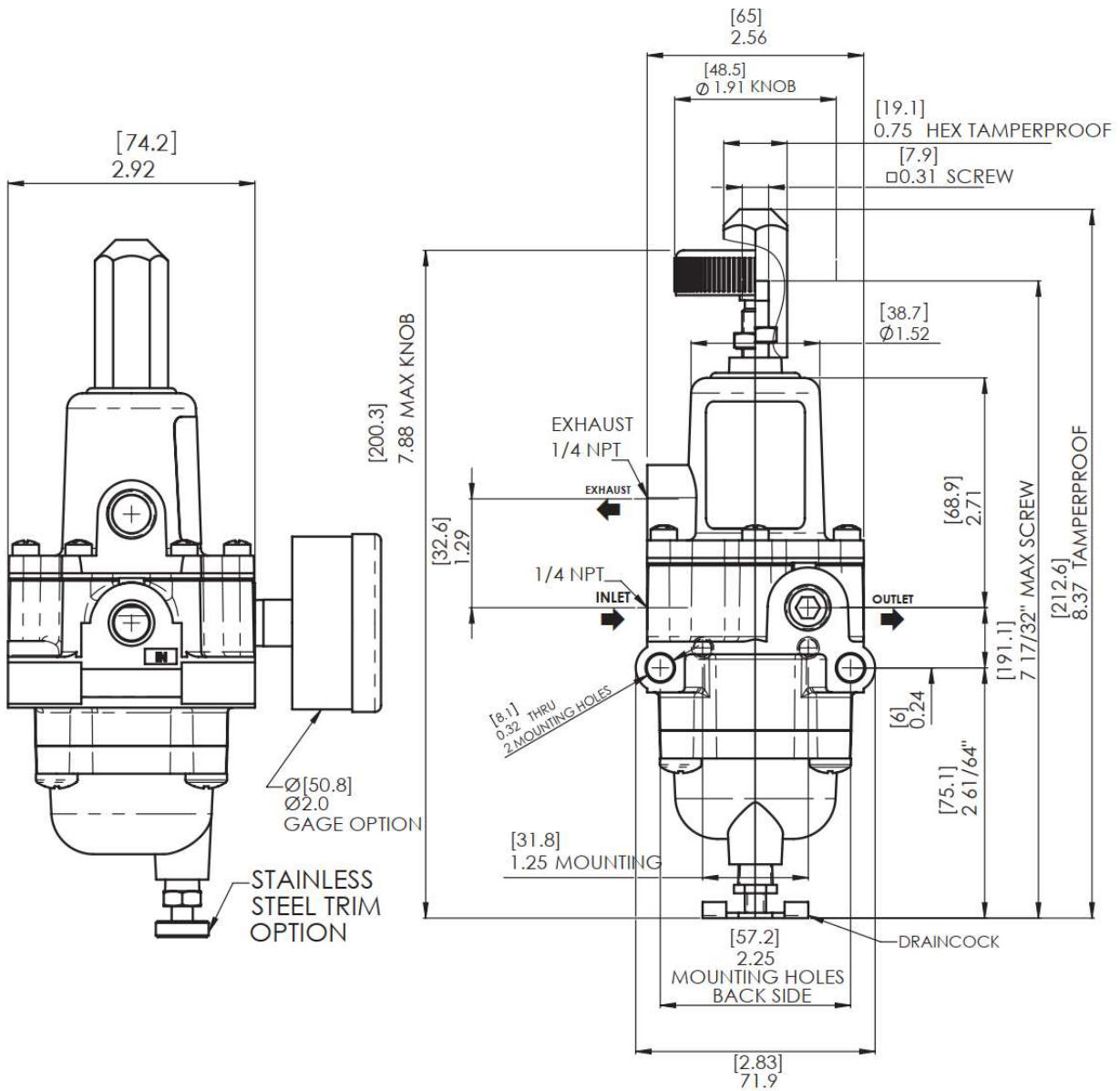

Figure 1. Outline Dimensions

INSTALLATION

Clean all pipelines to remove dirt and scale before installation. Ensure the drain is positioned at the lowest point.

Apply a minimum amount of pipe compound to only the male threads of the fitting. Do NOT use teflon tape as a sealant. Apply the sealant at least three threads back from the end of the fitting to avoid contaminating the regulator. Install the regulator in the air line.

Note the inlet and outlet ports are labeled “In” and “Out.” Securely tighten all connections. Avoid using undersized fittings that limit the flow of the regulator. See Figure 1.

Using the ¼” NPT connections, first connect the regulated device to the “OUT” port of the regulator. Then connect the air supply to the “IN” port of the regulator.

NOTE: Oil-free air must be applied to the regulator. If an air line lubricator is used, it MUST be located downstream of the regular to avoid performance interference.

OPERATION

The regulator has an adjustment screw which controls the output pressure. To increase pressure, turn the adjustment screw clockwise. To decrease pressure, turn the adjustment screw counterclockwise. See Figure 1.

MAINTENANCE

To remove entrained liquids from the dripwell, open the drain plug on the bottom of the dripwell assembly. The frequency of emptying the dripwell will be based on the flow through the regulator and the amount of entrained water/oil particles in the air line. See Figure 2.

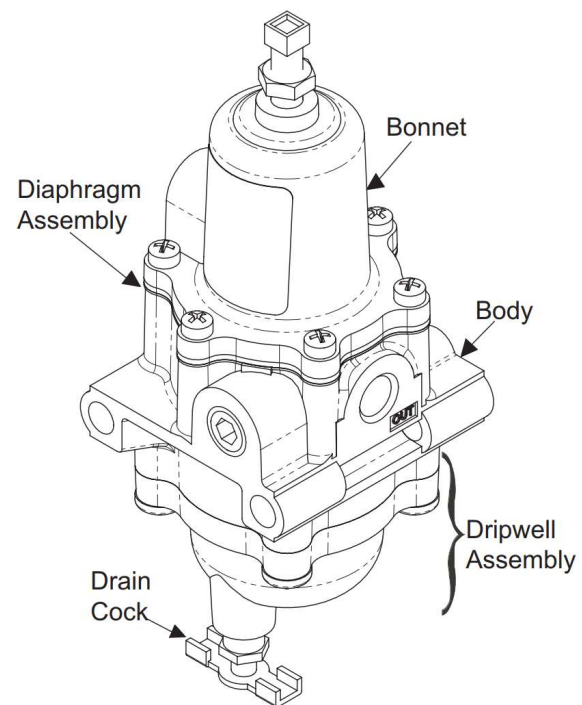

Figure 2. Part Breakdown

TROUBLE SHOOTING

Problem	Source	Solution
Leakage	Body Screw	Tighten the body screw
High Bleed	Relief Pintle or Relief Seat	If contaminated, clean the source
Difficult to Adjust	Adjustment Screw	Lubricate the adjustment screw