

SERIES V14

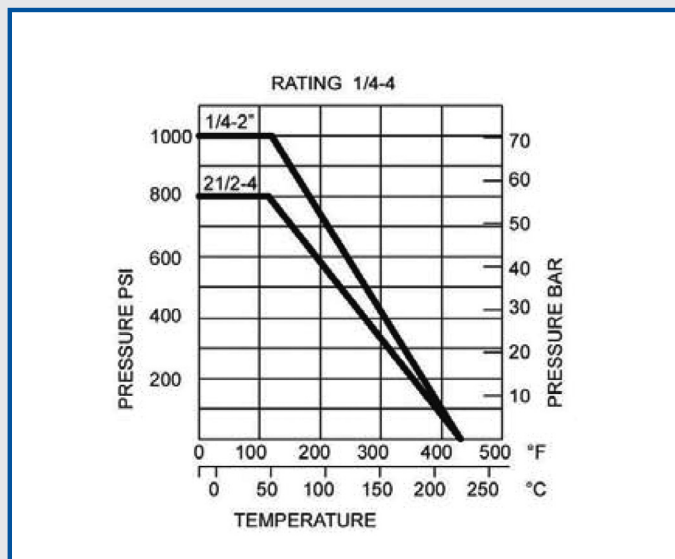

DIAGRAMMA PRESSIONE – TEMPERATURA
PRESSURE –TEMPERATURE CHART



CARATTERISTICHE

1. Valvola a Sfera a 2 vie a Passaggio Totale 3 pezzi
2. Estremità disponibili: filettate GAS (DIN 2999), filettate NPT (ANSI B 2.1), a saldare di tasca (ANSI B 16.11) e di testa (ANSI B 16.25)
3. Costruita in acciaio al carbonio WCB (V14W) oppure Inox AISI 316 (CF8M) (V14S)
4. Seggi in RPTFE
5. Boccola stelo PTFE
6. Sistema di bloccaggio
7. Sistema di antiespulsione
8. Max pressione di esercizio: 63 Kg/cm²
9. Temperatura di esercizio: -25°C +180°C

FEATURES

1. 2 way full port ball valve, 3 pieces
2. Available Ends: GAS thread (DIN 2999), NPT thread (ANSI B2.1), Socket Weld (ANSI B 16.11), Butt Weld (ANSI B 16.25)
3. Made in Carbon Steel WCB (V14W) or in AISI 316 (CF8M) (V14S).
4. Ball seats RPTFE
5. Stem gasket PTFE
6. Locking system
7. Blow-out proof stem
8. Max. working pressure 63 Kg/cm²
9. Working temperature -25°C +180°C

MATERIALI / MATERIALS

N°	Descrizione	Quantity	Material
1	Handle sleeve	1	Pvc
2	Handle	1	304
3	Gland nut	1	304/316
4	Stem nut	1	304
5	Stem washer	1	304
6	Stem packing	1	PTFE
7	Thrust washer	1	PTFE
8	End cap	2	CF8/CF8M
9	Bolt	4 (6)	304
10	Nut	4 (6)	304
11	Spring washer	4 (6)	304
12	Body	1	CF8/CF8M
13	Ball seat	2	RPTFE
14	Ball	1	CF8/CF8M
15	Stem	1	304/316
16	Locking device	1	304

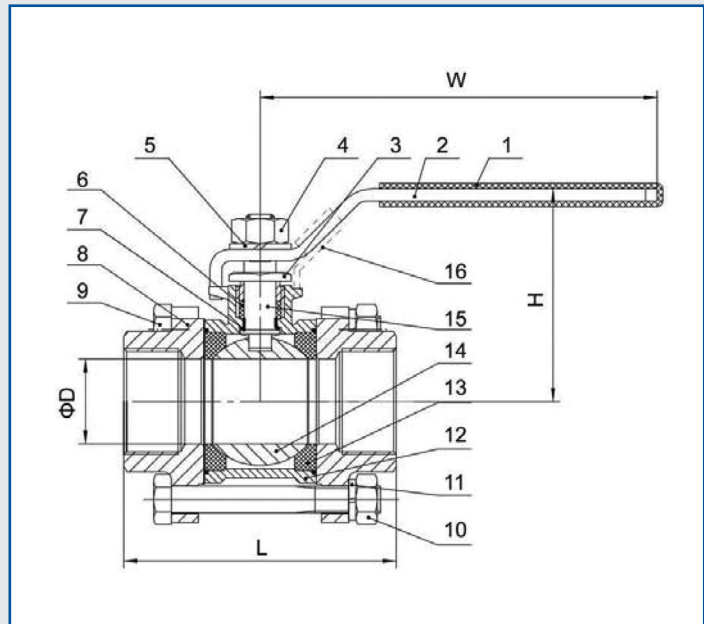

DIMENSIONI / DIMENSIONS

Ref. Code	Size	DN (mm)	PN (kg/cm ²)	D (mm)			T (mm) Butt Weld	k (mm) Socket Weld	S (mm) Socket Weld	L (mm)		H (mm)	W (mm)
				GAS & NPT Thread	Butt Weld	Socket Weld				NPT Thread & Socket Weld	Butt Weld		
PV02-V14abM14	1/4"	8	63	11	10,8	12	14,5	10	12	50	60,4	48	103
PV02-V14abI38	3/8"	10	63	12	11	12	15,9	10	12	50	60,4	48	103
PV02-V14abA12	1/2"	15	63	15	15	15	19,2	10	15	60	66,5	52	103
PV02-V14abB34	3/4"	20	63	20	20	20	23,4	13	20	70	80	61	123
PV02-V14abC10	1"	25	63	25	25	25	28,6	13	25	80	84	65	123
PV02-V14abD13	1 1/4"	32	63	32	32	32	38	13	32	93	104	79	153
PV02-V14abE15	1 1/2"	40	63	38	38	38	44	13	38	100	112	83	153
PV02-V14abF20	2"	50	63	50	50	50	56,5	16	50	125	132	97	185
PV02-V14abG25	2 1/2"	65	63	64	64	64	68	16	64	158	164	135	243
PV02-V14abH30	3"	80	63	76	76	76	86	16	76	179	182,2	144	243
PV02-V14abL40	4"	100	63	94	94	94	105	19	94	223	226,8	172	315

To complete the code, replace "a" with W = WCB; S = CF8M
replace "b" with G=Gas; N=NPT; B=Butt Weld; S=Socket Weld

